



## MyriaMesh Building Light Control multisensor motion/light

The MyriaMesh multisensor motion/light is part of the MyriaMesh Building Light Control product suite for wireless lighting control. The multisensor is a wireless motion detector and light sensor with a battery for flexible wall/ceiling mounting. The multisensor is able to automatically control lighting fixtures with MyriaMesh light control based on presence and light level.



### Safety

- Installation should be performed only by qualified personnel.
- Do not use the multisensor if it is damaged.
- This product contains a **non-replaceable** and **non-rechargeable** Lithium battery.
- The multisensor has protection class IP54 and is suitable for use at indoor and covered outdoor locations.

### Application

- Refer to the multisensor product sheet (see [chess-wise.eu/downloads](http://chess-wise.eu/downloads)) for the product specifications and the environmental conditions.

### Installation

1. Attach the mounting plate with at least 2 screws or double-sided adhesive tape to a wall or ceiling. Avoid positions vulnerable for mechanical impact (e.g. by transport carts).
2. Use the optional 45° bracket to mount the multisensor under an angle.
3. Insert the multisensor at one side in the mounting plate and push the multisensor until it locks.

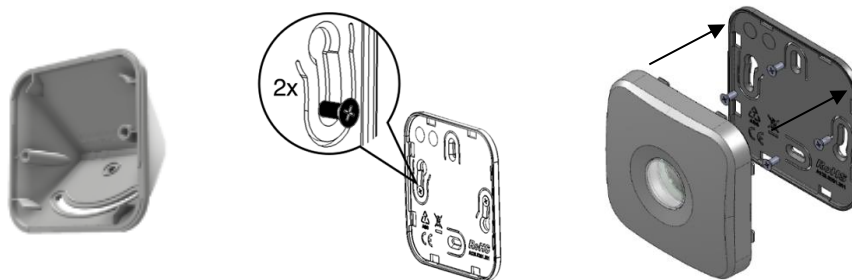

Contact information:  
[www.chess-wise.eu](http://www.chess-wise.eu)  
[info@chess-wise.eu](mailto:info@chess-wise.eu)  
Tel: +31 (0)23 51 49 149

Visit address:  
Chess Wise BV  
Richard Holkade 8A  
2033 PZ Haarlem  
The Netherlands

## Location

Mount the multisensor on the ceiling or wall. Take notice of the following:

- Point the multisensor at the desired detection zone. Refer to the product specifications for presence detection specifications.
- When the multisensor is used for daylight harvesting light control, it should be mounted such that no direct sunlight may beam on the sensor. Also avoid indirect sunlight, e.g. by reflection on water surfaces or parked cars direct outside the room.
- Ensure that the multisensor is not influenced by lighting of another group in the room.

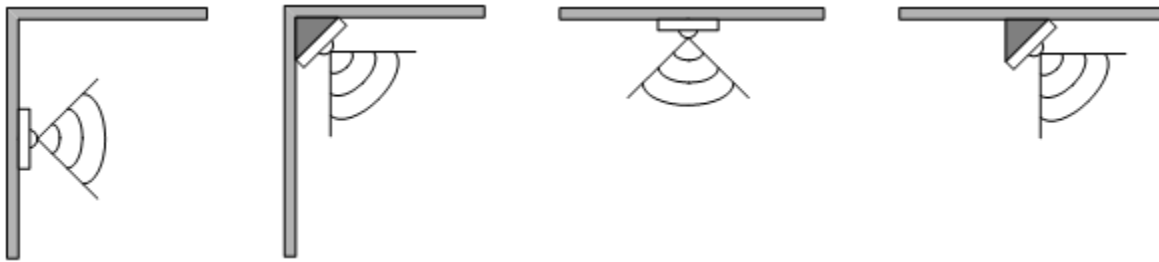

Mounting examples

## Configuration

Use the iPad MyriaMesh Light commission app for configuration of the multisensor. Enable *commission mode* by operation of the hidden push button (see arrow on bottom) until the LED flashes 3x. The motion detection is active in *commission mode* (red LED on = motion detected). After operation of the push button or 60 sec the multisensor will go to *normal mode* again.

Operate push button for	LED	Function
3 sec	3x	Commission mode (after 60 sec back to normal mode)
short	2x	Normal mode



press and hold

Following configuration options are available:

- Presence detection (one or more sensors)
- Daylight harvesting light control (one sensor)
- Presence detection (one or more sensors) and daylight harvesting light control (one sensor)

The multisensor is standard configured for presence detection.

## Calibration

A multisensor configured for daylight harvesting light control will perform a calibration procedure during the night within 24h after installation. During the calibration lights will be switched on shortly. Recalibration is needed after movement of the multisensor to another location. This can be initiated in the iPad Light commission app.

Note: do **not** switch off the lighting by means of a building or floor switch during the calibration period.

A multisensor (configured for daylight harvesting light control) continuously measures the actual light level in the room and tries to keep this on the level measured during calibration. In this way lights in the room are controlled based on the amount of incoming day light. If needed, the control set point can be increased or decreased by a manual correction factor in the iPad commission app.

## Usage

After commissioning with the iPad the multisensor will return to *normal mode* and operates autonomous in the MyriaMesh network.

## Compliance

This product complies with the European directives and relevant standards for low voltage, EMC, RED, REACH and RoHS. The multisensor motion/light contains a radio. The applied radio frequency is within the ISM band 2400 – 2483.5 MHz (default 2403 MHz) and the maximum transmit power is +4 dBm. Hereby, Chess Wise declares that the radio equipment type multisensor motion/light is in compliance with Directive 2014/53/EU. The full text of the EU declaration of conformity is available at [chess-wise.eu/downloads](http://chess-wise.eu/downloads).

## Repair

Do not open this product. In case of failure the multisensor must be replaced.



## Recycling

Do not dispose this product as household waste, but bring it to an appropriate collection point for recycling.

Contact information:  
[www.chess-wise.eu](http://www.chess-wise.eu)  
[info@chess-wise.eu](mailto:info@chess-wise.eu)  
Tel: +31 (0)23 51 49 149

Visit address:  
Chess Wise BV  
Richard Holkade 8A  
2033 PZ Haarlem  
The Netherlands